

Manual-Scoop Shower No. 16

Change of black gaskets (16-1, 16-2, 16-3) Use installation tools (16-M)

1. Close water supply at the ball valve (16-13) and apply shower once.
2. Unscrew spray head (16-9) from shower body (16-12).
3. Unscrew valve tappet (16-8) from blue nozzle pin (16-5). Use screw-wrench kit.
4. Replace gasket (16-1) at the valve tappet.
5. Replace gasket (16-2) at the spray head (16-9).
6. Replace gasket (16-3) at the spray head (16-9).
7. Insert valve tappet (16-8) and nozzle pin (16-5) into valve unit (16-9) and screw on – 14 turns!
8. Screw the assembled spray head tightly into the shower body (16-12).

Replacement of red gaskets (16-4, 16-6)

9. Close water supply at the ball valve (16-13) and apply shower once.
10. Unscrew shower (16) from ball valve (16-13).
11. Replace gasket (16-6) between sink bottom and shower body (16-12) as well as gasket (16-4) between sink bottom and ball valve (16-13).
12. Screw together tightly ball valve (16-13) and shower (16).

Warning:

- **Install the shower to a cold water connection only!**
- Turn off water supply while the shower is not used!
- Check installation before use!

Spare part list

Screw-wrench kit (16-M)
Gasket (16-1)*
Gasket (16-2)*
Gasket (16-3)*
Gasket (16-4)*
Nozzle pin (16-5)
Gasket (16-6)*
Valve tappet (16-8)
Spray head (16-9)
Perlator (16-10)
Spring (16-11)
Shower body (16-12)
Ball valve (16-13)
* included in
screw-wrench kit (16-M)

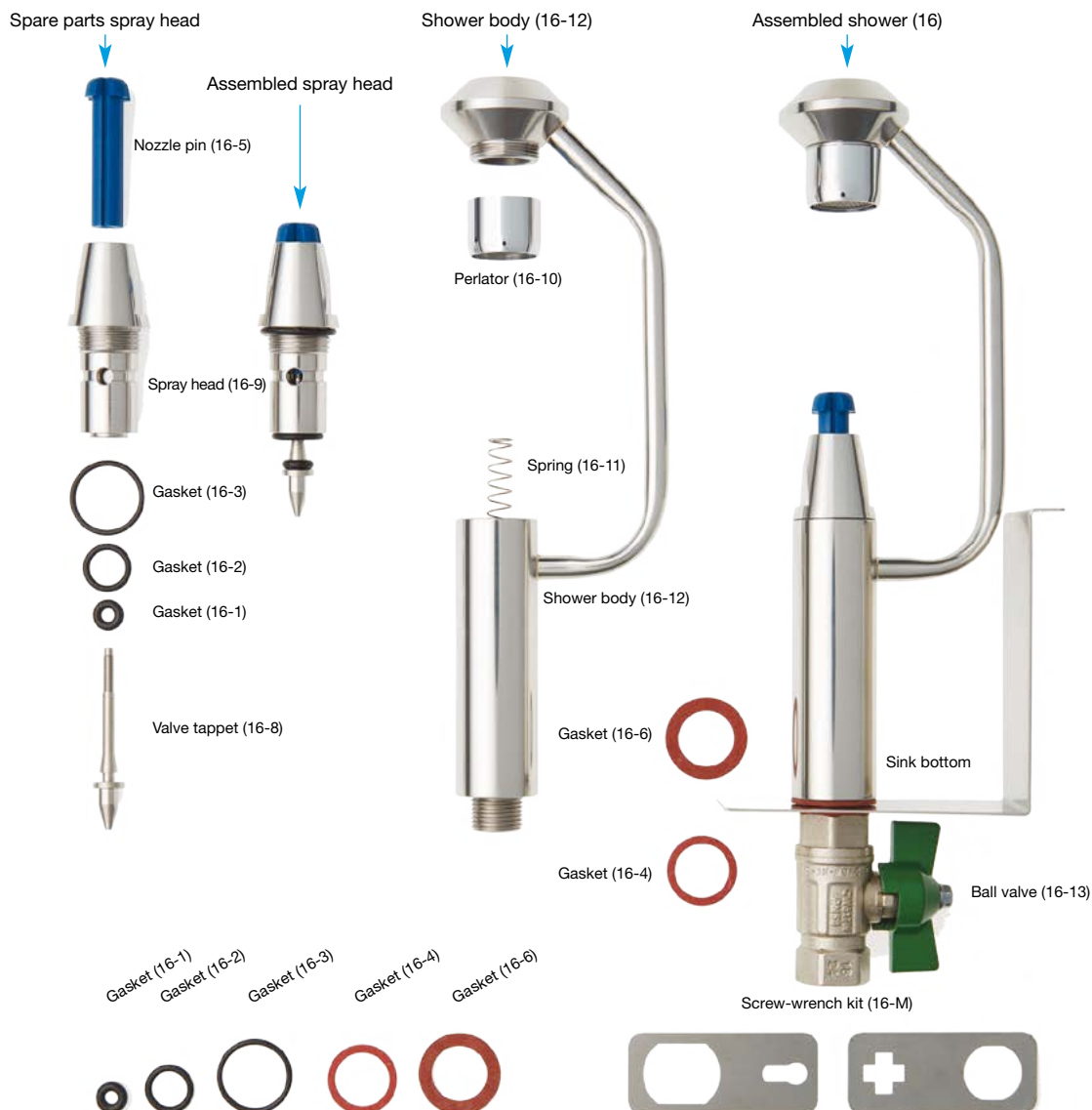

Manual-Scoop Shower No. 16

Change of black gaskets (16-1, 16-2, 16-3) Use installation tools (16-M)

1. Close water supply at the ball valve (16-13) and apply shower once.
2. Unscrew spray head (16-9) from shower body (16-12).
3. Unscrew valve tappet (16-8) from blue nozzle pin (16-5). Use screw-wrench kit.
4. Replace gasket (16-1) at the valve tappet.
5. Replace gasket (16-2) at the spray head (16-9).
6. Replace gasket (16-3) at the spray head (16-9).
7. Insert valve tappet (16-8) and nozzle pin (16-5) into valve unit (16-9) and screw on – 14 turns!
8. Screw the assembled spray head tightly into the shower body (16-12).

Replacement of red gaskets (16-4, 16-6)

9. Close water supply at the ball valve (16-13) and apply shower once.
10. Unscrew shower (16) from ball valve (16-13).
11. Replace gasket (16-6) between sink bottom and shower body (16-12) as well as gasket (16-4) between sink bottom and ball valve (16-13).
12. Screw together tightly ball valve (16-13) and shower (16).

Warning:

- **Install the shower to a cold water connection only!**
- Turn off water supply while the shower is not used!
- Check installation before use!

Spare part list

- Screw-wrench kit (16-M)
- Gasket (16-1)*
- Gasket (16-2)*
- Gasket (16-3)*
- Gasket (16-4)*
- Nozzle pin (16-5)
- Gasket (16-6)*
- Valve tappet (16-8)
- Spray head (16-9)
- Perlator (16-10)
- Spring (16-11)
- Shower body (16-12)
- Ball valve (16-13)
- * included in screw-wrench kit (16-M)